

VISITOR INFORMATION GUIDE

DATE: Thursday 11 September 2025

VENUE: UWS Ayr Campus

UCAS



GETTING HERE

UCAS



GETTING HERE

UWS Ayr Campus

University Avenue

Ayrshire

KA8 0SX

Use What3Words to find us! [///thus.jungle.grapes](https://www.what3words.com/this-jungle-grapes)



TRAVELLING BY CAR OR COACH?

Free car parking will be available in Car Park 1. As there is a barrier system in operation; one of our colleagues will be on duty, please inform them you are a visitor, and you will be given access to the car park. Once parked, please make your way to Level 3 where the exhibition will take place. To exit the car park, simply drive towards the exit barrier, this will lift automatically as you approach.

Coach drop off/collection will be available at the roundabout next to the Visitors Car Park. Use what3words to find us: [///thus.jungle.grapes](https://www.what3words.com/this-jungle-grapes) One of our attendants will be on duty to direct you. No charges apply. Coach parking is NOT available.

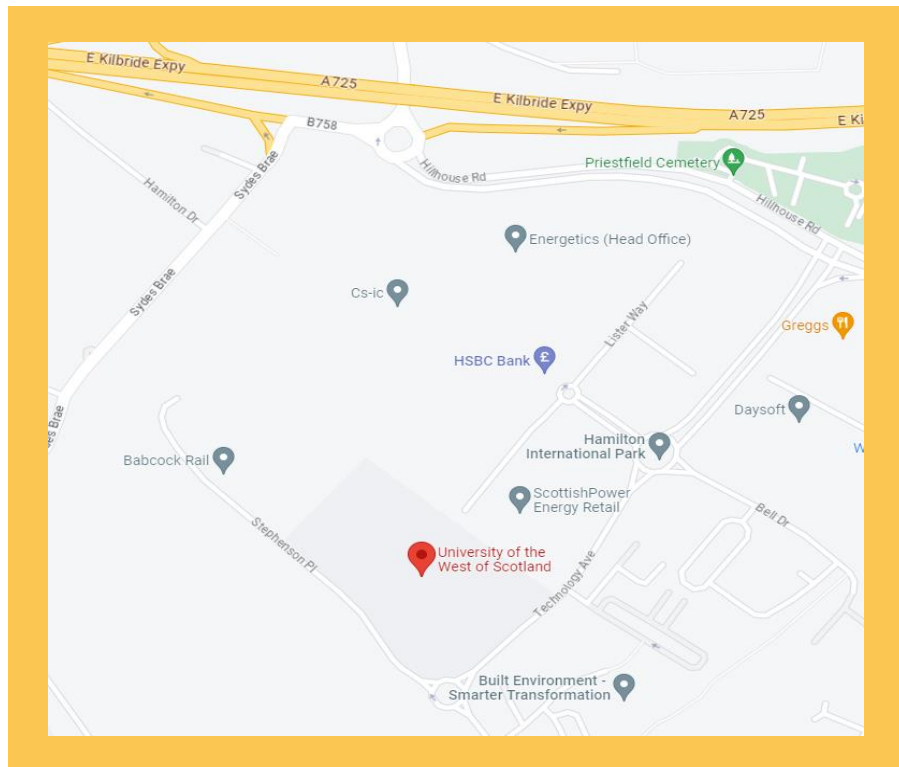

WHILST YOU'RE HERE

WHEN YOU ARRIVE



On arrival, please head to the main entrance located at Level 3 to check in. Please have your ticket ready for inspection. If you don't have a ticket on arrival, please report to the registration desk. Once checked in, please head to Level 2 to the main exhibition area.



Your exhibition ticket is personal to you and should not be passed on to other group members, as this could compromise the security of your data. To comply with data protection regulations, it's essential that individuals at our exhibitions use their own ticket – both on entering, and when visiting exhibitors' stands. Anyone found to be in breach of this will be asked to leave the event and register again to be readmitted.



Please be aware, the venue may be conducting random bag searches. We thank you for your patience while this takes place.



WHILST YOU'RE HERE

UCAS

WIFI

Network: UWS_Guest WiFi

Password: UWS_Welcome

ACCESSIBILITY

Our Campus is fully accessible and there are accessible toilet facilities located throughout the venue. Please ask staff if you are unsure.

CATERING

There will be refreshments available for visitors to purchase in the coffee shop and restaurant. Purchases can be made via card only.

WATER FOUNTAINS

Water fountains can be found in the corridors outside the toilet facilities.

TOILET FACILITIES

Toilet facilities can be found throughout the venue. Please refer to the campus map on page 7.

QUIET ROOM

Study room 1 is available to anyone who needs a quite place to go to during the event. Please ask a events staff for directions.

EVENT STAFF

For general queries during the event (e.g. directions to facilities), ask any of the event staff, who can be identified by their UCAS-branded t-shirts.

The Big Q&A and Subjects Talks

Student talks will run throughout the event in **Lecture Theatre 2** which is located on **Level 4** and will be signposted. A full programme of events can be found on the [event webpage](#).



JUST IN CASE

UCAS

ORGANISERS

If you wish to speak to the event organiser, they will be based in the exhibition venue, and can also be identified by UCAS branded t-shirts. If you need to speak to the organiser by phone prior to the event, please call Laura Murdoch on 07787669054.

ACCIDENTS & NEAR MISSES

If you are involved in, or witness an accident or near miss while on-site, please report it at the General Information desk immediately.

EMERGENCY PROCEDURES

Should an evacuation of the building occur, please follow the instruction of the event staff, and leave the build via the nearest exit.

FIRST AID

If you sustain any personal injuries or are present while an accident occurs, please report in the first instance to the UCAS General Information desk,



FREQUENTLY ASKED QUESTIONS

UCAS

- **WHAT INSURANCE IS IN PLACE FOR THE EVENT?**

The organiser has adequate public and employee liability cover. While the organisers take every precaution to protect visitors' property during an event, they are not responsible for any loss or damage. All group leaders should ensure they have adequate public and employers' liability cover, in line with the booking terms and conditions.

- **WHAT HAPPENS TO ANY LOST PROPERTY?**

If any property is lost or found in the venue, please report it to the organiser.

- **CAN I SMOKE/VAPE ON SITE?**

There is a strict no smoking/vaping policy on the University Campus.

- **WHAT SECURITY IS THERE?**



Security is present throughout the event. We do advise you not to leave valuables or personal belongings unattended.

- **WHERE CAN I GET A COPY OF THE RISK ASSESSMENT FOR THE EVENT?**

The organiser has completed a risk assessment for the event and this can be accessed by logging in your group booking and selecting the Risk Assessment tab.

FIND YOUR WAY - EVENT MAP

AYRSHIRE (11TH SEPTEMBER 2025)

-  Universities & Colleges
-  Employers & Apprenticeships
-  Information and Advice

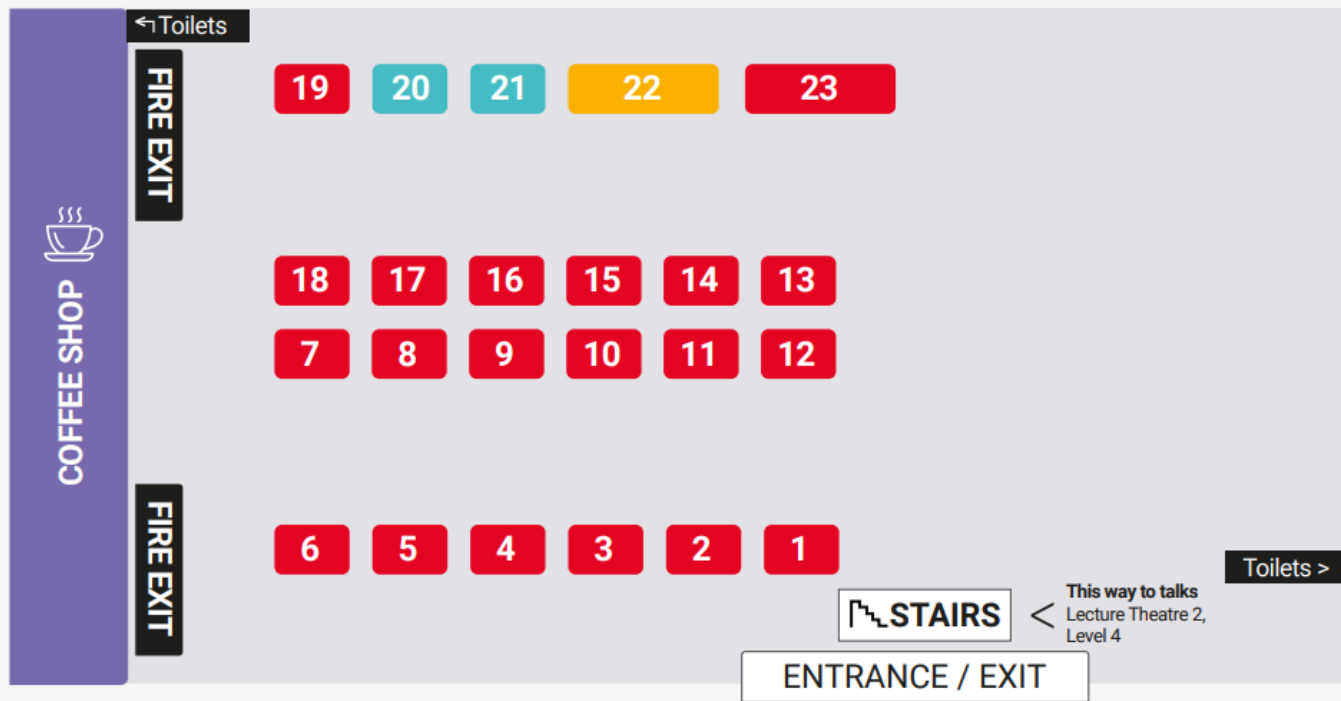

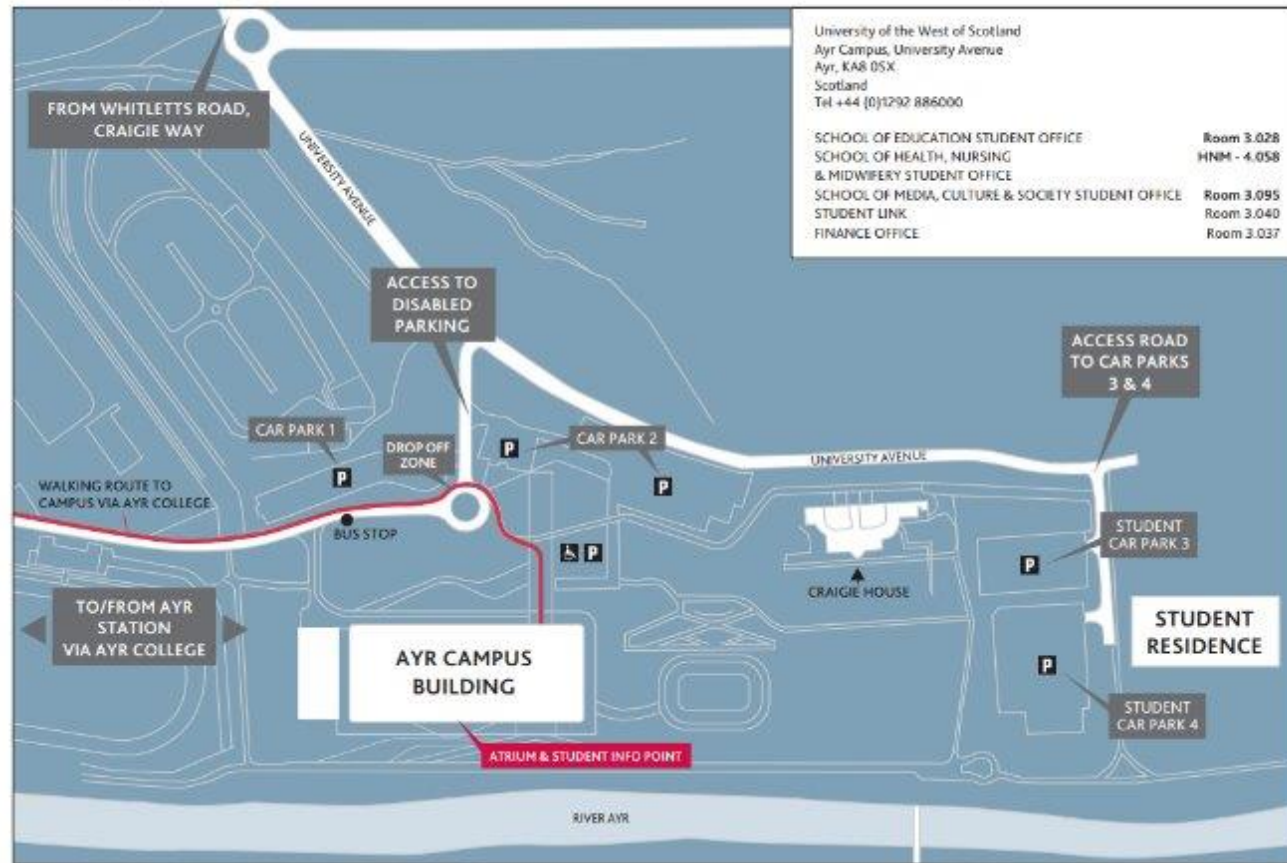



UCAS

CONTACT DETAILS

VENUE

Laura Murdoch

Laura.Murdoch@uws.ac.uk

07787669054

CONTACT DETAILS

Prior to the exhibition

01242 544 808 or email

events@ucas.ac.uk

ON SITE GENERAL ENQUIRIES

Event ambassadors, wearing UCAS t-shirts, will also be available to offer help and advice if you have any queries

Thank you for registering to attend the **Event** UCAS
Discovery exhibition.

